



**Let's deorbit
your spacecraft
together!**

Why using a deorbit sail?

Because no launch is no option!

Comply to the 5-year deorbiting rule, and deorbit your dead CubeSats and SmallSats fast and reliably with our commercial, multiple times flight-proven, deployable dragsail. Deorbit sails are cheap, small, lightweight, and easy to integrate. Our ADEO product family offers the perfect deorbiting solution for your specific spacecraft and mission, without wasting any propellant.



Interested in ADEO?

Contact us:

HPS GmbH
Hofmannstr. 25-27
81379 Munich, Germany

+49 89 45 20 576-0
@ adeo@hps-gmbh.com

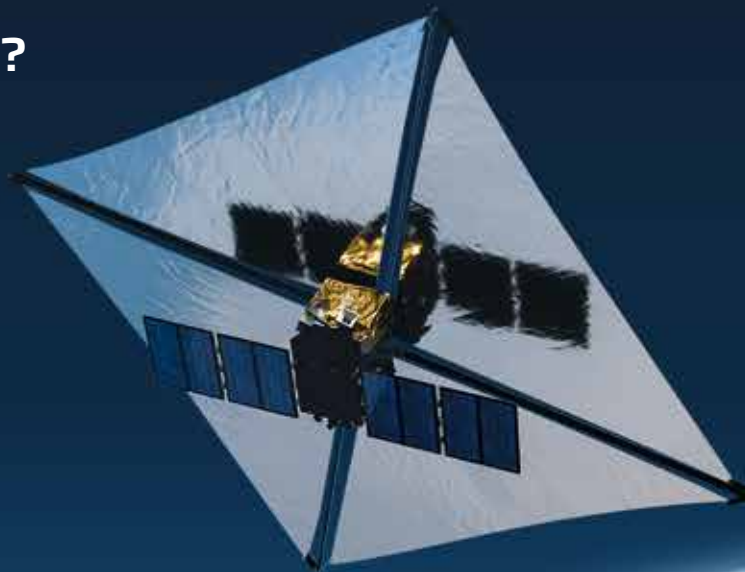

The ADEO Product Family

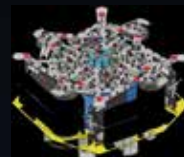
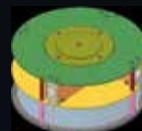
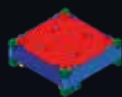

	ADEO-P(ico)	ADEO-C(ube)	ADEO-N(ano)	ADEO-M(edium)	ADEO-L(arge)
S/C mass	1-20 kg	5-50 kg	20-250 kg	100-700 kg	500-1500 kg
ADEO mass	0.45 kg	0.8 kg	0.8 kg	4.5 kg	9.5 kg
ADEO size	10 x 10 x 3.9 cm ³	9.5 x 9.5 x 7.2 cm ³	10 x 10 x 10 cm ³	D 29 cm/H 13.4 cm	40.6 x 40.6 x 26 cm ³
Sail area	1.7 m ²	3.4 m ²	5.0 m ²	15 m ²	25 m ²
Mechanism	Spring-based	Spring-based	Spring-based	Spring-based	Electrical-based
Activation	Pyro cutter	Pyro cutter	Pyro cutter	Pyro cutter	Release Nut
Mechanical interface	4 x M4 thread	CubeSat Standard	4 x M5 thread (D8.2 cm)	8 x M6 thread (D27.5 cm)	8 x 7.0 mm hole (D28/29 cm)
Electrical interface	2 Wires (free ends)	4 Wires (free ends)	2 Wires (free ends)	4 Wires (free ends)	3 Connectors D-Sub HD15, RS422
Electrical power	12V@1A for 10 msec	>1V@3A for 25 msec	12V@1A for 10 msec	>1V@3A for 25 msec	24-38 V

ADEO has been developed since 2014 with ESA technology development, co-funded by ESA, DLR, Bavaria, and own investments, in collaboration with many companies and institutes.

Need more information about ADEO?

Scan the QR code or check out our website and online configurator:

<https://www.hps-gmbh.com/portfolio/adeo-deployable-dragsails/>



Has ADEO been flown and verified? YES, multiple times!

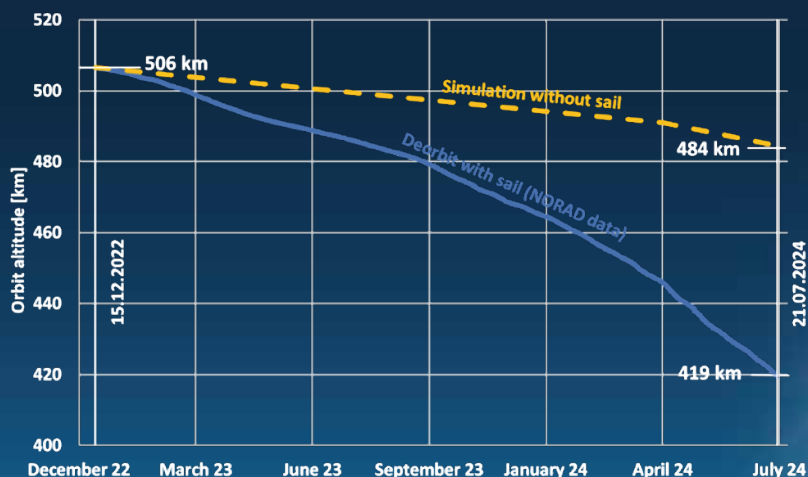

Orbital decay ION-SCV003 (D-Orbit, Italy) 210 kg, with ADEO-N2 (3.6 m² sail)